

# SHC/A2 HORIZONTAL PLATE CLAMP

## SDC/A1 VERTICAL DRUM LIFTING CLAMP

### SHC/A2 HORIZONTAL PLATE CLAMP



THE SHC/A2 Horizontal Plate Clamps are for use in the lifting and transfer in horizontal position of non-sagging materials or of bundles of non-sagging material. These clamps must be used in pairs or more.

1. Wide variety of jaw openings available: 0 to 40 mm.
2. Individually proof tested to 200% of WLL with Certification.
3. Each product is individually serialized, with IP, Logo, serial number and proof Load Test date stamped on body. Serial number is included on the test certificate with maintenance and warranty logbook.
4. Manufactured by an ISO9001 facility.

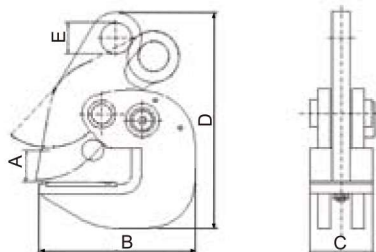

Item NO	WLL(Ton)		Test Load(Ton)		Jaw opening (mm)	Dimensions(mm)					Net weight kg
	Single	Double	Single	Double		A	B	C	D	E	
SHC/A2-0075	0.75	1.50	1.13	2.25	0 - 25	25	125	50	50	φ25	2.4
SHC/A2-0150	1.50	3.00	2.25	4.50	0 - 25	30	157	65	65	φ30	3.9
SHC/A2-0250	2.50	5.00	3.75	7.50	0 - 40	50	231	90	90	φ40	14.0

### SDC/A1 VERTICAL DRUM LIFTING CLAMP



DESIGNED TO LIFT, MOVE AND TRANSFER 50-50 GALLON DRUMS WITH STEEL TOPS.

1. Available in capacity of 5 metric tons.
2. Welded alloy steel body for strength and smaller size. Forged alloy components, where required.
3. Individually Proof Tested to 2 times the Working Load limit with certification.
4. company name (IP), logo, Working Load limit and jaw opening permanently stamped on body.
5. Each product is individually serialized, with the serial number and Proof Load test date stamped on body. Serial number is included on the test certificate with maintenance and warranty logbook.
6. Minimum WLL of 10% of Maximum WLL.
7. Maintenance replacement kits are available.
8. Manufactured by an ISO9001 facility.

Model	Working Load Limit (t)*	SDC/A1 Stock No.	Weight Each (lbs.)	Dimension(in.) 尺寸					
				Jaw A	B	C	D	E	F
SDC/A1-0050	0.5	2700118	15	12	14.77	11.42	1.97	5.94	0.47